

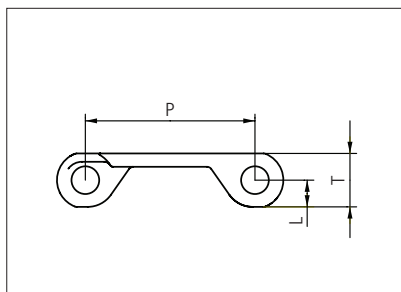

# Plastic Modular Belt

Series **uni UCB** Type **Closed**

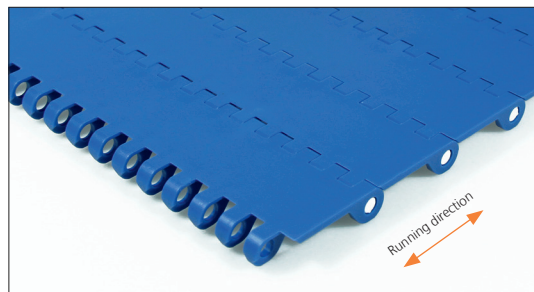

Straight running belt  
 Nominal pitch: 50.8 mm (2.00 in)  
 Surface type: Flat  
 Surface opening: Closed  
 Backflex radius: 65.0 mm (2.6 in)  
 Pin diameter: 8.0 mm (0.31 in)

Belt material & color	POM-D <span style="border: 1px solid black; padding: 0 2px;">W</span> <span style="border: 1px solid black; padding: 0 2px;">B</span>	PP-I <span style="border: 1px solid black; padding: 0 2px;">W</span> <span style="border: 1px solid black; padding: 0 2px;">B</span>	PE-I <span style="border: 1px solid black; padding: 0 2px;">N</span> <span style="border: 1px solid black; padding: 0 2px;">B</span>	P (Nominal)	mm	in	T	mm	in
	Pin material & color				50.8	2.00		16.0	0.63
Pin material & color			PE <span style="border: 1px solid black; padding: 0 2px;">W</span>	L	8.0	0.31	-	-	-

Non standard material and color: See uni Material and Color Overview.

Belt width		Permissible tensile force (Belt/pin material)						Belt weight (Belt/pin material)						*Min. No. drive sprocket per shaft	Number of wear strips (Min. No.)	
		POM-D/PP		PP-I/PP		PE-I/PE		POM-D/PP		PP-I/PP		PE-I/PE			**Carry (pcs)	**Return (pcs)
mm	in	N	lbf	N	lbf	N	lbf	kg/m	lb/ft	kg/m	lb/ft	kg/m	lb/ft			
152	6.0	1596	359	958	215	365	82	1.2	0.80	0.8	0.55	0.8	0.57	2	2	2
203	8.0	2132	479	1279	287	487	110	1.6	1.07	1.1	0.73	1.1	0.76	3	3	2
253	10.0	2657	597	1594	358	607	136	2.0	1.33	1.4	0.91	1.4	0.95	3	3	2
304	12.0	3192	718	1915	431	730	164	2.4	1.60	1.6	1.10	1.7	1.14	4	4	2
354	13.9	3717	836	2230	501	850	191	2.8	1.86	1.9	1.28	2.0	1.33	4	4	3
405	15.9	4253	956	2552	574	972	219	3.2	2.13	2.2	1.46	2.3	1.52	5	5	3
455	17.9	4778	1074	2867	644	1092	245	3.6	2.39	2.4	1.64	2.5	1.71	5	5	3
506	19.9	5313	1194	3188	717	1214	273	4.0	2.66	2.7	1.83	2.8	1.90	6	6	4
556	21.9	5838	1312	3503	787	1334	300	4.3	2.92	3.0	2.01	3.1	2.09	6	6	4
607	23.9	6374	1433	3824	860	1457	327	4.7	3.19	3.3	2.19	3.4	2.28	7	7	4
657	25.9	6899	1551	4139	930	1577	354	5.1	3.45	3.5	2.37	3.7	2.46	7	7	5
708	27.9	7434	1671	4460	1003	1699	382	5.5	3.72	3.8	2.56	4.0	2.66	8	8	5
758	29.8	7959	1789	4775	1074	1819	409	5.9	3.98	4.1	2.74	4.2	2.84	8	8	5
809	31.9	8495	1910	5097	1146	1942	436	6.3	4.25	4.3	2.92	4.5	3.03	9	9	6
859	33.8	9020	2028	5412	1217	2062	463	6.7	4.51	4.6	3.10	4.8	3.22	9	9	6
910	35.8	9555	2148	5733	1289	2184	491	7.1	4.78	4.9	3.28	5.1	3.41	10	10	6
960	37.8	10080	2266	6048	1360	2304	518	7.5	5.05	5.2	3.46	5.4	3.60	10	10	7
1011	39.8	10616	2386	6369	1432	2426	545	7.9	5.31	5.4	3.65	5.6	3.79	11	11	7

Additional standard belt widths are available in steps of 50.4 mm (2.00 in).

1971	77.6	20696	4652	12417	2791	4730	1063	15.4	10.36	10.6	7.11	11.0	7.39	20	20	13
------	------	-------	------	-------	------	------	------	------	-------	------	------	------	------	----	----	----

Additional standard belt widths are available in steps of 50.4 mm (2.00 in).

2981	117.4	31301	7036	18780	4222	7154	1608	23.3	15.67	16.0	10.76	16.6	11.18	30	30	20
------	-------	-------	------	-------	------	------	------	------	-------	------	-------	------	-------	----	----	----

General belt tolerance is +0/-0.4% at 23°C/73°F. For exact belt width contact Customer Service.

Additional non-standard belt widths are available in steps of 16.8 mm (0.66 in).

\*Max. Load per Drive Sprocket. Belt material: POM-DI 1000 N (225 lbf), PPI 660 N (149 lbf), PEI 170 N (38 lbf).

\*\*Max. Spacing between wear strips, Carry: 101.0 mm (4.00 in); return: 152.0 mm (6.00 in).

= Single Link



Member of Ammega Group.  
 ammega.com

STANDARD

STRAIGHT RUNNING

PITCH 50.8 MM/2.00 IN

**Accessories**

**Flight**

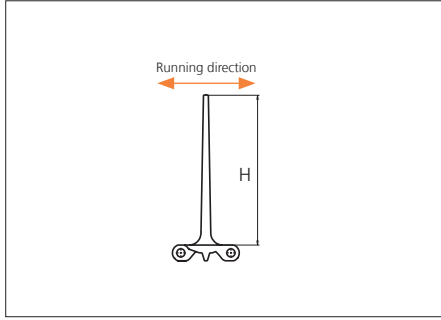
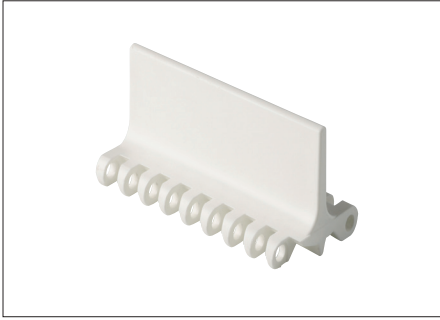

Type	Material & color	H		Link size	Width		Indent both sides	
		mm	in		mm	in	mm	in
Flat	POM-D <span style="border: 1px solid black; padding: 2px;">W</span> <span style="background-color: #0056b3; color: white; padding: 2px;">B</span> PP-I <span style="border: 1px solid black; padding: 2px;">W</span> <span style="background-color: #0056b3; color: white; padding: 2px;">B</span> PE-I <span style="background-color: #f0f0f0; padding: 2px;">N</span> <span style="background-color: #0056b3; color: white; padding: 2px;">B</span>	5.0	0.20	K600	151.0	5.94	3.0	0.12
		10.0	0.39					
		25.4	1.00					
		50.8	2.00				0.0	0.0
		76.2	3.00					
		101.6	4.00					
		101.6	4.00					
152.4	6.00	34.0*	1.34					
		0.0	0.00					

\*Indent only in one side.

Depending on height and spacing the use of product supports may influence the backflex radius.  
 Other flights are available: see uni MPB Flights datasheet.

**Accessories**

**Side Guard**

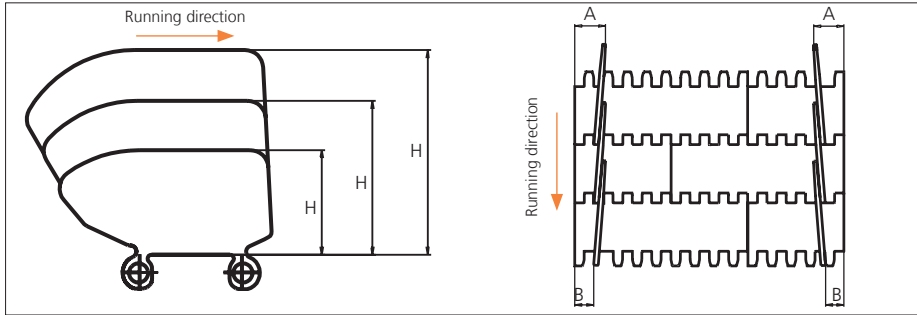
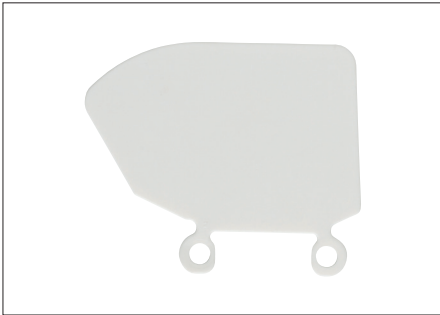

Type	Side Guard Material & color	H		A		B	
		mm	in	mm	in	mm	in
Closed	PP-I <span style="border: 1px solid black; padding: 2px;">W</span> <span style="background-color: #0056b3; color: white; padding: 2px;">B</span> PE-I <span style="background-color: #f0f0f0; padding: 2px;">N</span> <span style="background-color: #0056b3; color: white; padding: 2px;">B</span>	50.8	2.00	32.0	1.26	16.0	0.63
		76.2	3.00				
		101.6	4.00				

\*34.0 mm (1.34 in) combined with flight. Increment: 8.4 mm (0.33 in).  
 Note: Backflex radius when Side Guards are used: 200.0 mm (7.90 in)

## Sprocket

No of teeth	Bore size								Overall diameter		Pitch-diameter		Hub-diameter		Dimension A		Dimension B		Single row/One way	Molded PA6 LG	Machined PA6	
	Pilot bore	in		1.00		1.18		1.25														
		mm	25.4	30.0	31.8	38.1	40.0	60.0	63.5													
Z08	✓		●	●	●	■	■			132.9	5.23	132.8	5.23	65.0	2.56	53.3	2.10	74.9	2.94	✓	✓	
Z10	✓			●	●	●	■	■		166.3	6.55	164.4	6.47	65.0	2.56	70.2	2.76	90.7	3.57	✓	✓	
Z10								■	■	166.3	6.55	164.4	6.47	120.0	4.72	70.2	2.76	90.7	3.57	✓	✓	
Z12	✓			●	●	●	■	■		198.6	7.82	196.3	7.73	65.0	2.56	86.8	3.42	106.6	4.19	✓	✓	
Z12								■	■	198.6	7.82	196.3	7.73	120.0	4.72	86.8	3.42	106.6	4.19	✓	✓	
Z16	✓			●	●	●	■	■	■	263.8	10.39	260.4	10.25	150.0	5.90	119.7	4.71	138.7	5.46	✓		✓

● Molded sprocket

■ Machined sprocket

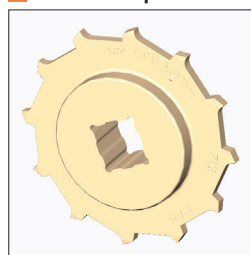
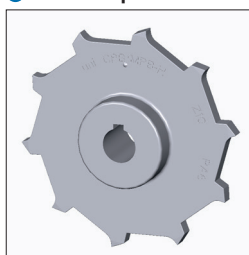

Other sprocket sizes are available upon request.

Other bore sizes on sprockets are available upon request.

Max. load per sprocket shown does not take bore size into account.

Please also ensure that sufficient size shaft is chosen for corresponding load.

Width of tooth = Single row: 9.5 mm (0.37 in)

Width of One-part sprocket = Single row: 42.3 mm (1.67 in)

## uni UltraClean One-Part and Two-Part Sprocket

No. of teeth	Bore size				Overall diameter		Pitch-diameter		Hub-diameter		Dimension A		Dimension B		Single row/One way	Moulded PA6 W
	in		1.50													
	mm	38.1	40.0	60.0	mm	in	mm	in	mm	in	mm	in	mm	in		
Z8		1 <sup>1</sup> 2 <sup>2</sup>	1 <sup>1</sup> 2 <sup>2</sup>		132.9	5.23	132.8	5.23	165.0 <sup>1</sup> 277.0 <sup>2</sup>	12.56 <sup>1</sup> 23.03 <sup>2</sup>	53.3	2.10	74.9	2.94	✓	✓
Z10		1 <sup>1</sup> 2 <sup>2</sup>	1 <sup>1</sup> 2 <sup>2</sup>	2 <sup>2</sup>	166.3	6.55	164.4	6.47	165.0 <sup>1</sup> 2126.0 <sup>2</sup>	12.56 <sup>1</sup> 24.96 <sup>2</sup>	70.2	2.76	90.7	3.57	✓	✓
Z12		1 <sup>1</sup> 2 <sup>2</sup>	1 <sup>1</sup> 2 <sup>2</sup>	2 <sup>2</sup>	198.6	7.82	196.3	7.73	165.0 <sup>1</sup> 2126.0 <sup>2</sup>	12.56 <sup>1</sup> 24.96 <sup>2</sup>	86.8	3.42	106.6	4.19	✓	✓

■ Moulded uni UltraClean OnePart Sprocket

■ Moulded uni UltraClean TwoPart Sprocket

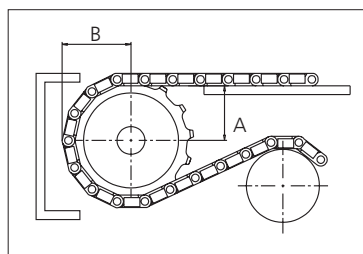
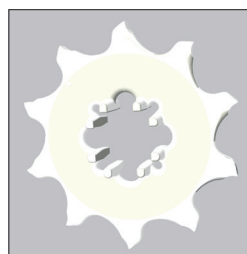

Width of UltraClean Two-part sprocket

= Single row: 44.0 mm (1.73 in)

Width of UltraClean Two-part sprocket, tooth

= Single row: 9.5 mm (0.37 in)

uni Retainer Rings: See uni Retainer Ring datasheet.

For correct sprocket position:

See uni Assembly instructions for uni MPB.

More detailed sprocket information:

contact Customer Service.

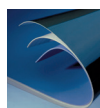

Synthetic Belts



Endless Woven Belts

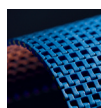

Modular Belts

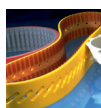

Engineered Belts



Homogeneous Belts



Fabrication & Service

Expert advice and quality solutions for all your belting needs.  
ammeraalbeltech.com

Ammeraal Beltech Modular A/S  
Hjulmagervej 21  
DK-7100 Vejle  
T +31 7572 3100

ammega.com

This information is subject to alteration due to continuous development. Ammeraal Beltech will not be held liable for the incorrect use of the above stated information. This information replaces previous information. All activities performed and services rendered by Ammeraal Beltech are subject to general terms and conditions of sale and delivery, as applied by its operating companies.

Member of Ammega Group.